

# 3304COPT

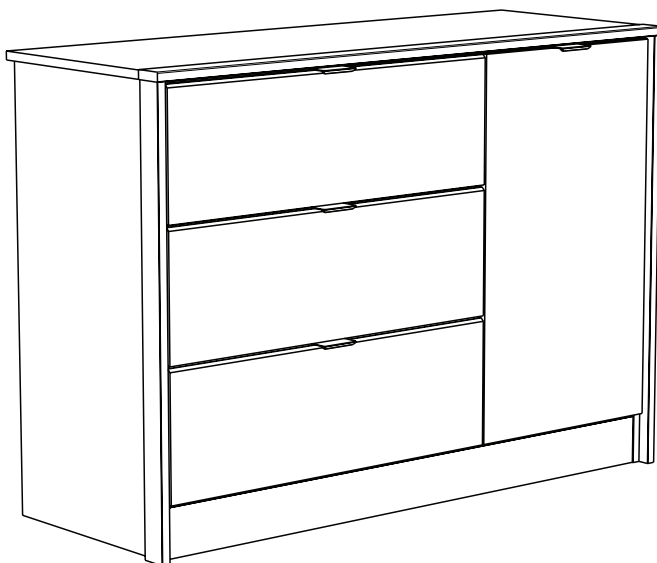

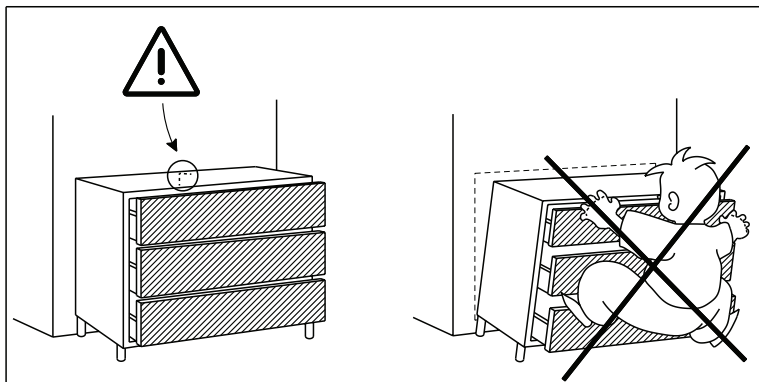
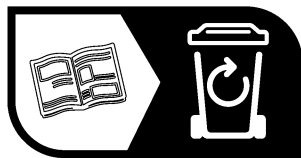
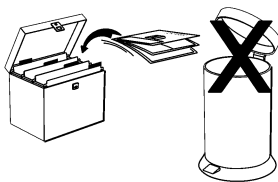

FR

Donnez ou recyclez  
vos meubles.



ou



ou



Association

Magasin

Déchèterie

<https://quefairedemesdechets.fr>

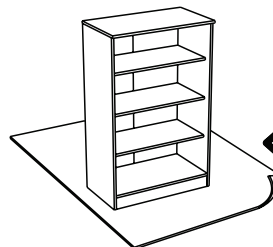
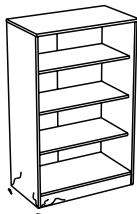
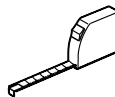
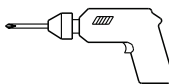
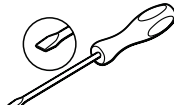
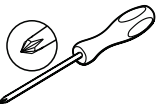
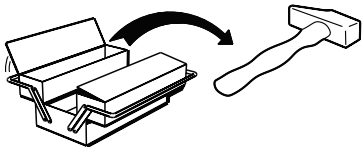

80.5cm  
31 3/4"  
113cm  
44 1/2"  
42.5cm  
16 3/4"

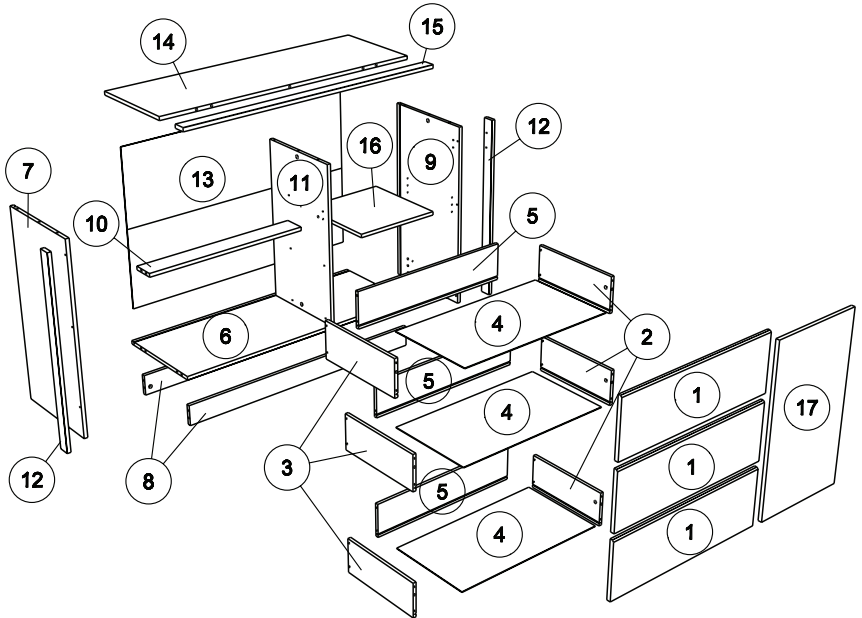

		mm			inch		
16	x 1	372	372	15	14 5/8	14 5/8	9/16
10	x 1	678	86	15	26 11/16	3 3/8	9/16
1	x 3	682	226	15	26 7/8	8 7/8	9/16
11	x 1	684	377	15	26 15/16	14 13/16	9/16
17	x 1	686	392	15	27	15 7/16	9/16
12	x 2	786	47	16	30 15/16	1 7/8	5/8
7	x 1	786	398	15	30 15/16	15 11/16	9/16
9	x 1	786	398	15	30 15/16	15 11/16	9/16
8	x 2	1065	86	15	41 15/16	3 3/8	9/16
6	x 1	1065	397	15	41 15/16	15 5/8	9/16
14	x 1	1127	372	15	44 3/8	14 5/8	9/16
15	x 1	1129	50	16	44 7/16	1 15/16	5/8
2	x 3	350	138	13	13 3/4	5 7/16	1/2
3	x 3	350	138	13	13 3/4	5 7/16	1/2
5	x 3	628	138	13	24 3/4	5 7/16	1/2
4	x 3	640	349	3	25 3/16	13 3/4	1/8
13	x 1	1081	700	3	42 9/16	27 9/16	1/8

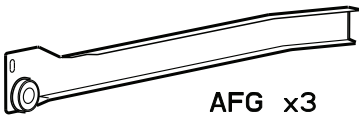

AFG x3

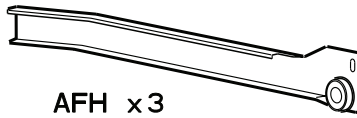

AFH x3

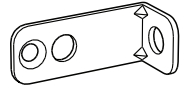

BLL x1



AFi x3

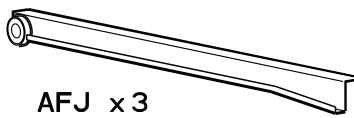

AFJ x3



Ai x20

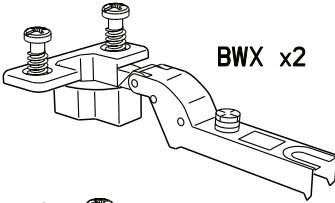

BWX x2

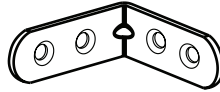

LN x2



BZG x6

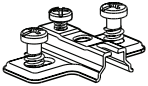

BWU x2

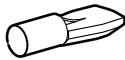

BWD x4

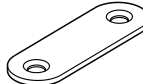

BJJ x2



EP x6

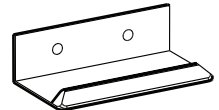

POi x4

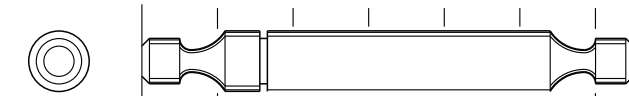
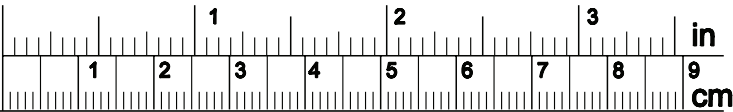

AKY x3

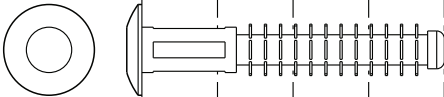

CQA x12

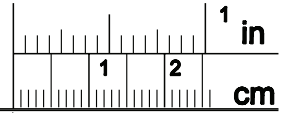

ADM x20



QA x14



ADU x12



BWF x12

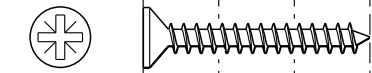

WF x6

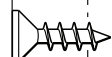

VG x27

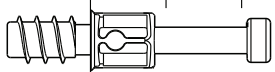

BSD x20



ANK x14

**1**

**BSD x 6**

**ADU x 12**

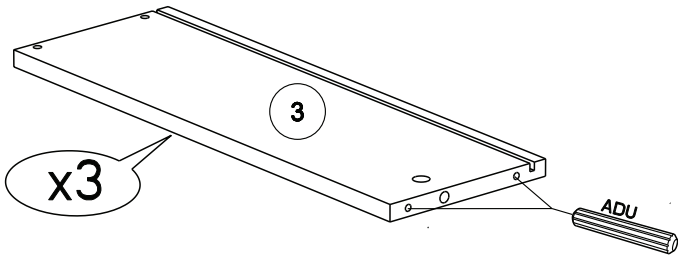
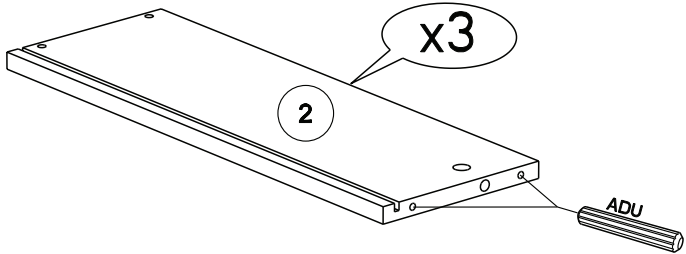
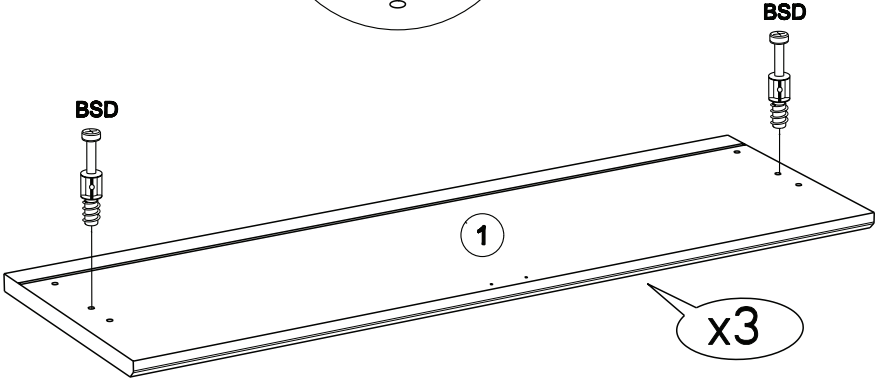
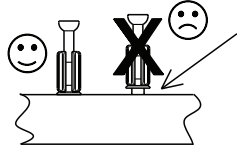
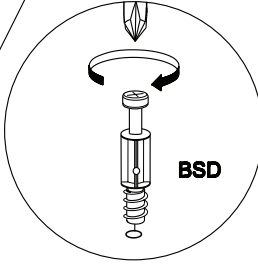

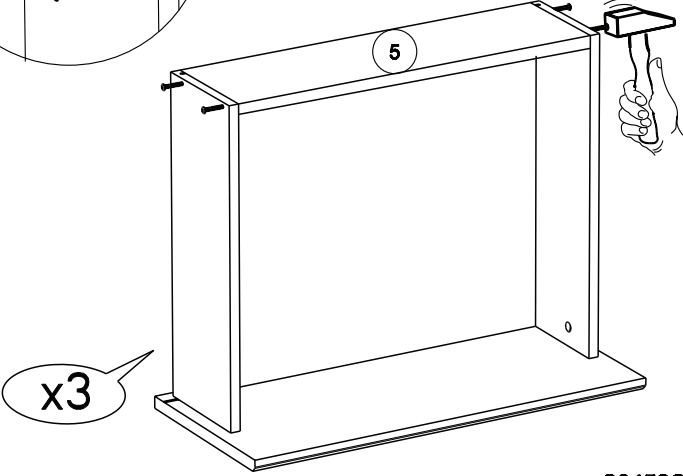
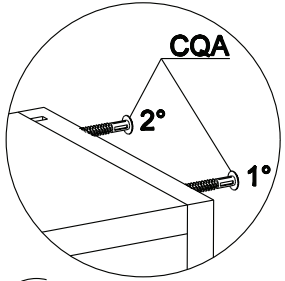
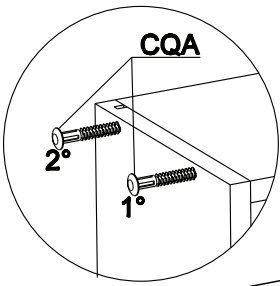
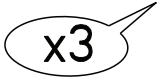
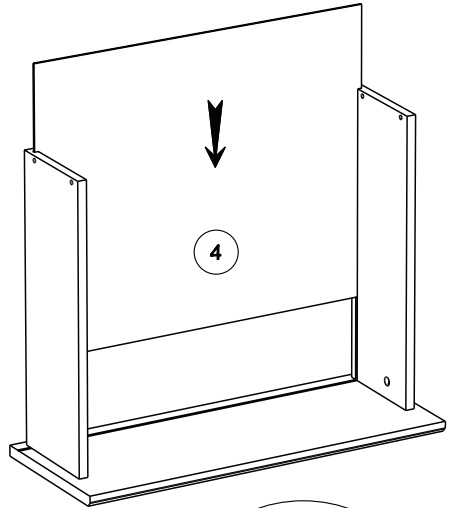
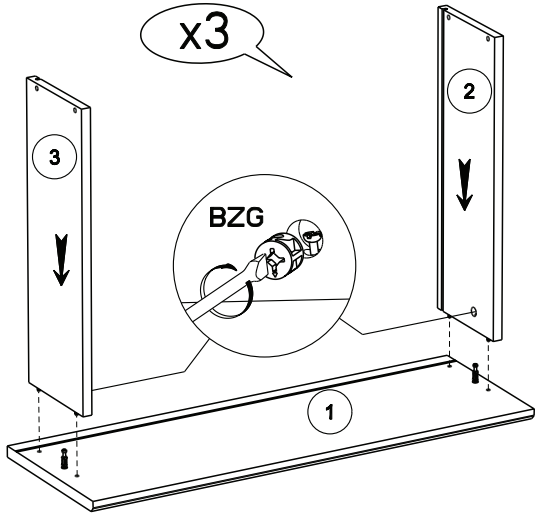
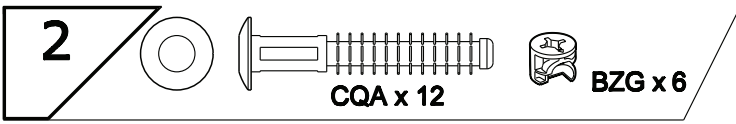

**3**

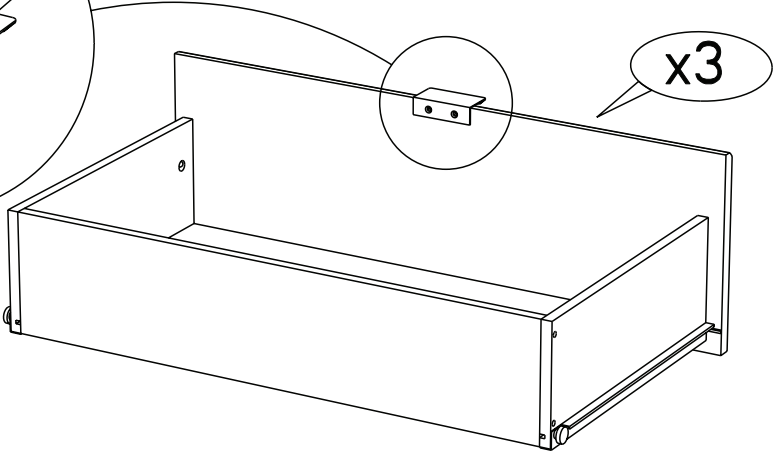
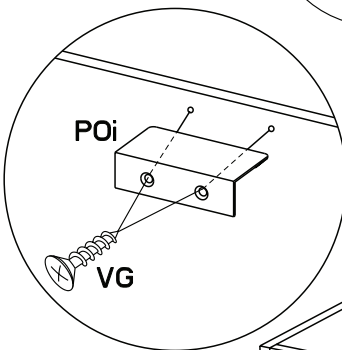
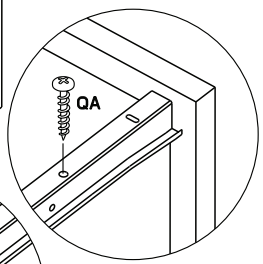
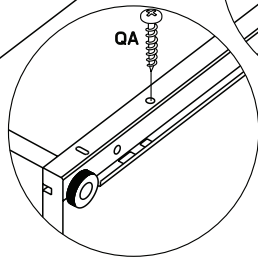
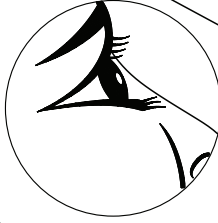
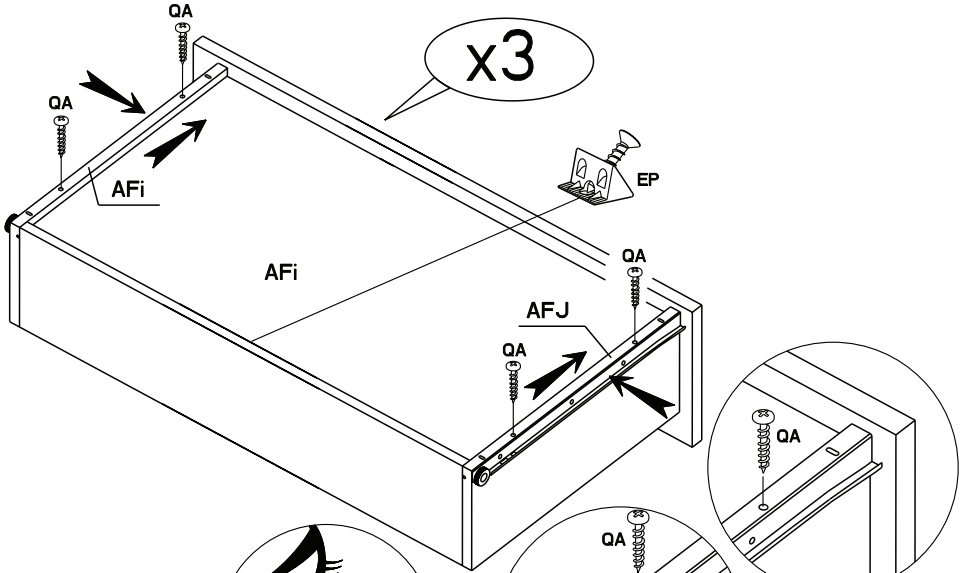
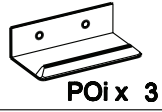
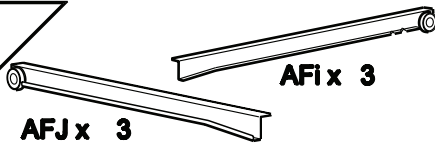

**4**

ADM x 4

ANK x 2

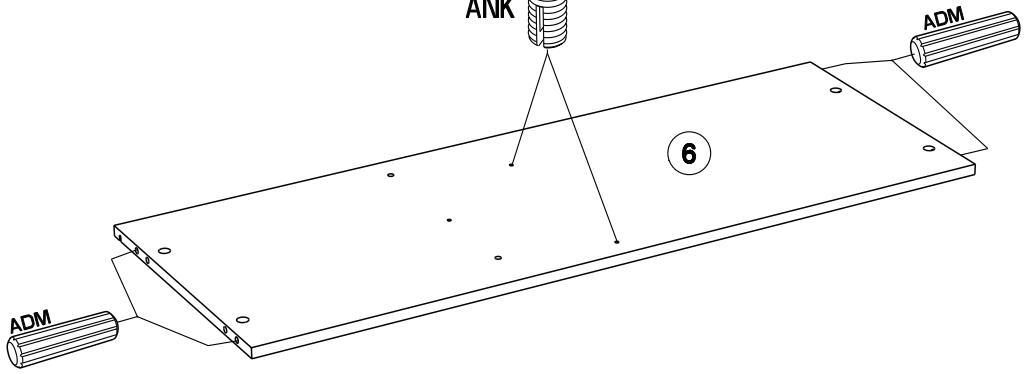

**5**

ADM x 4

LN x 2

ANK x 2

VG x 4

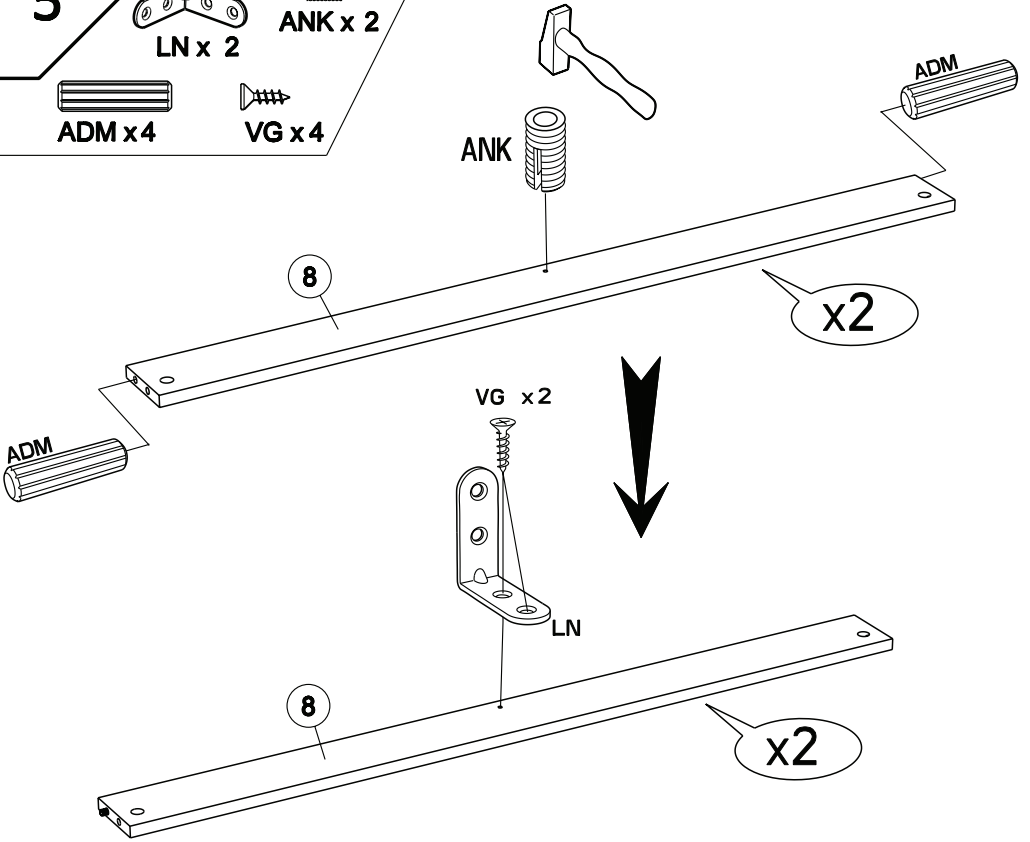



6

BSD x 5

ADM x 2

AFG x 2

BWF x 4

VG x 2

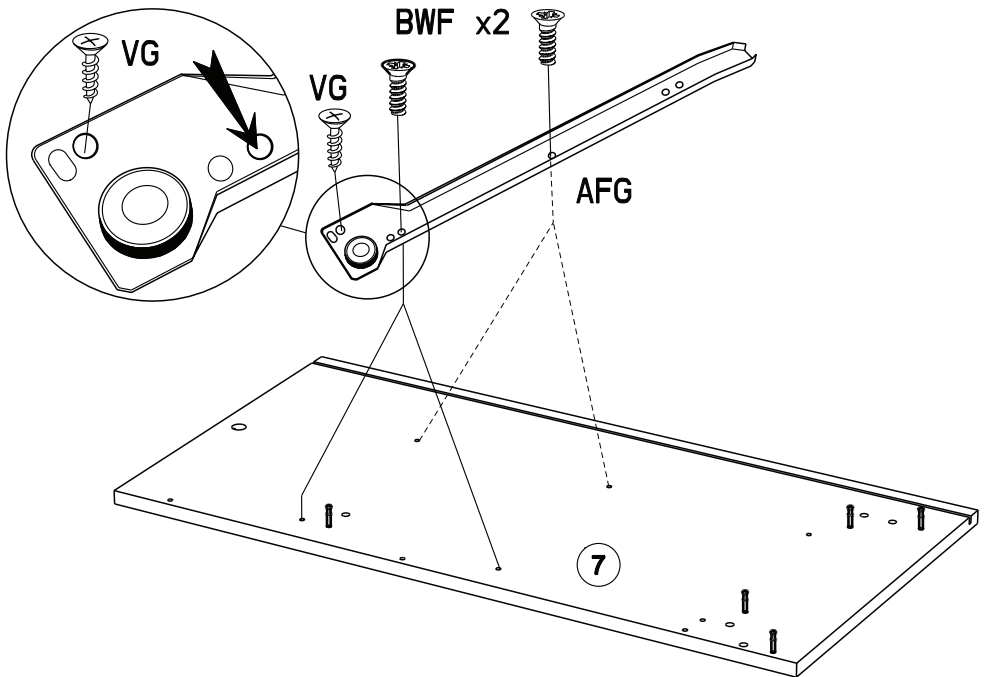
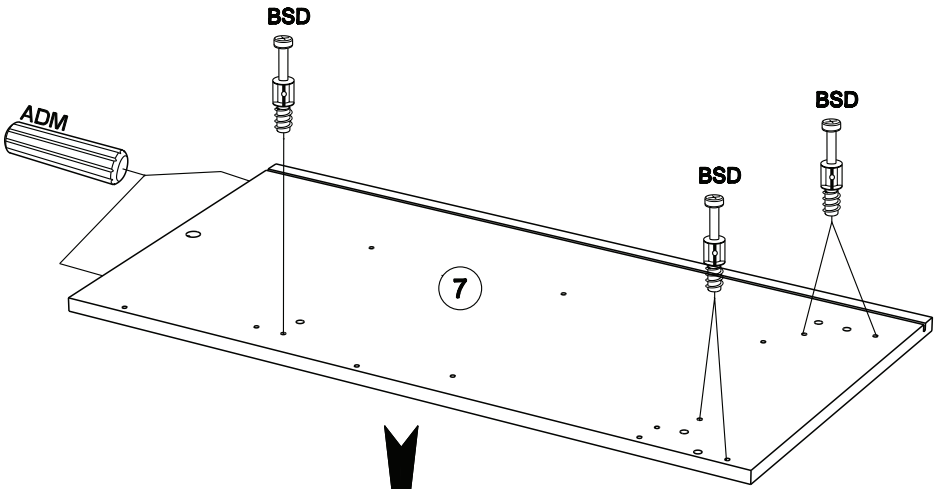

7

  
BSD x 4

  
ADM x 2

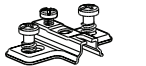
  
BWU x 2

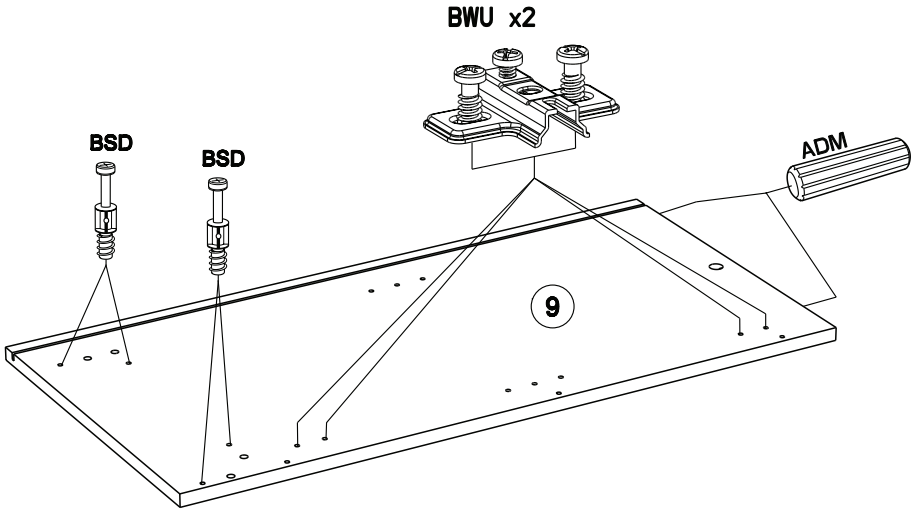

8

  
ANK x 8

  
ADM x 2

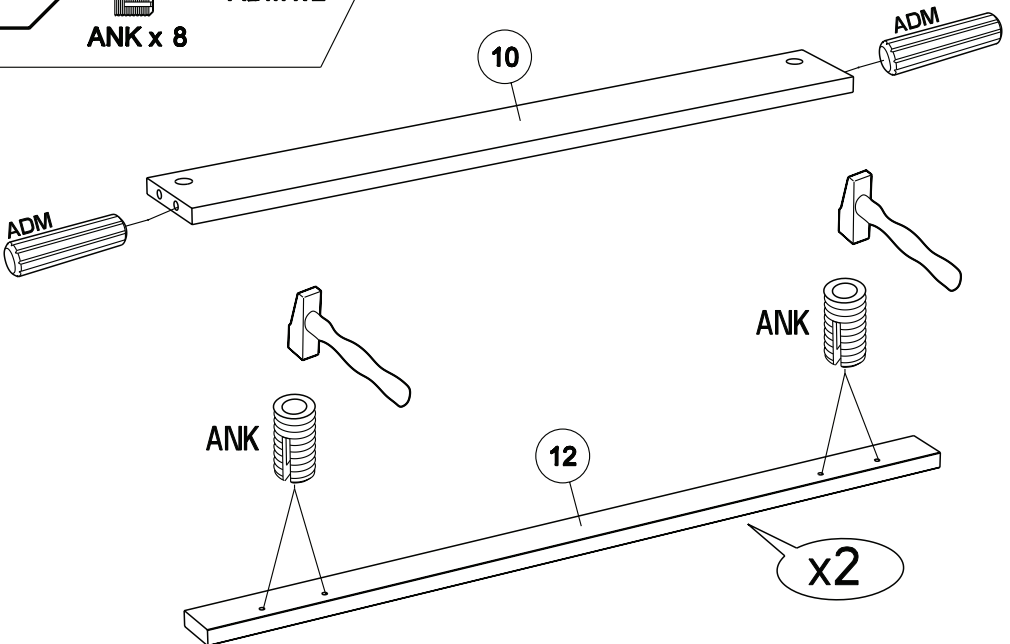

9



BSD x 1



ADM x4



AFH x2



BWF x 4



VG x2

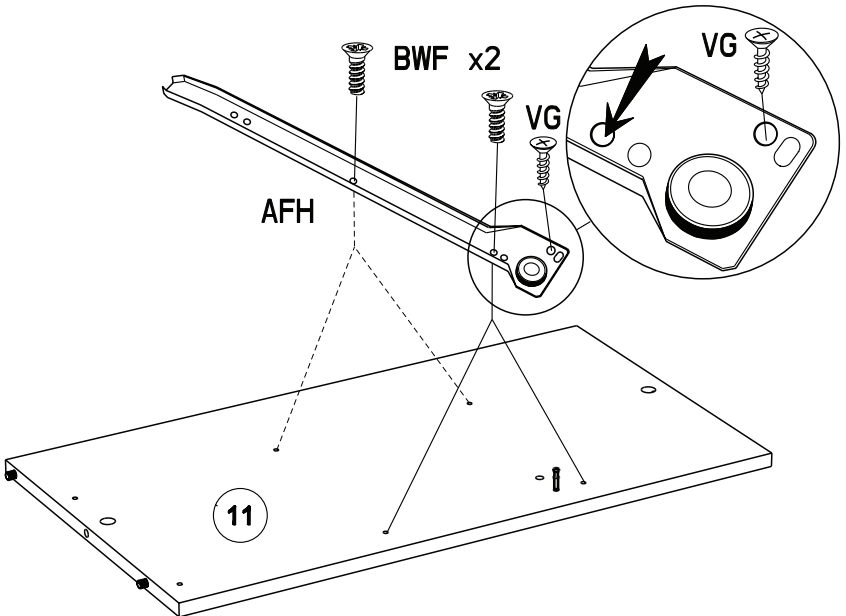
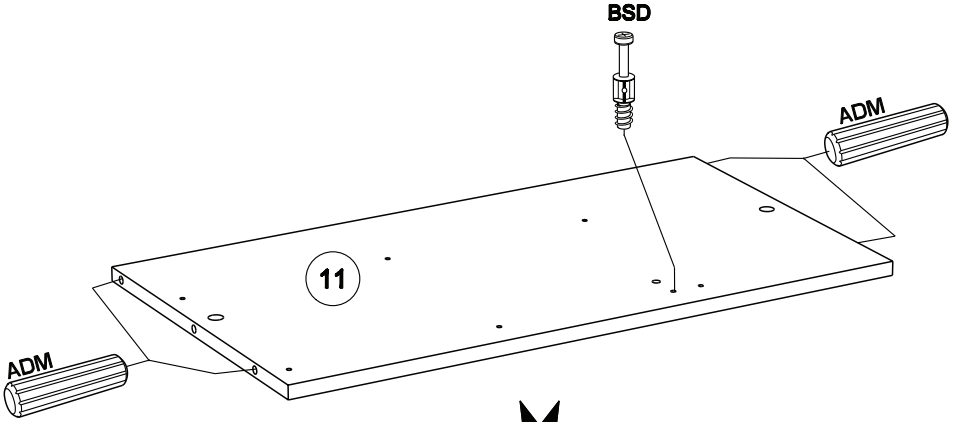

10



Ai x4



VG x4

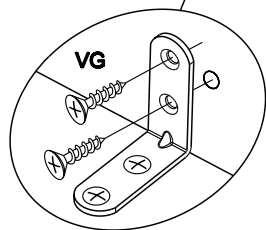
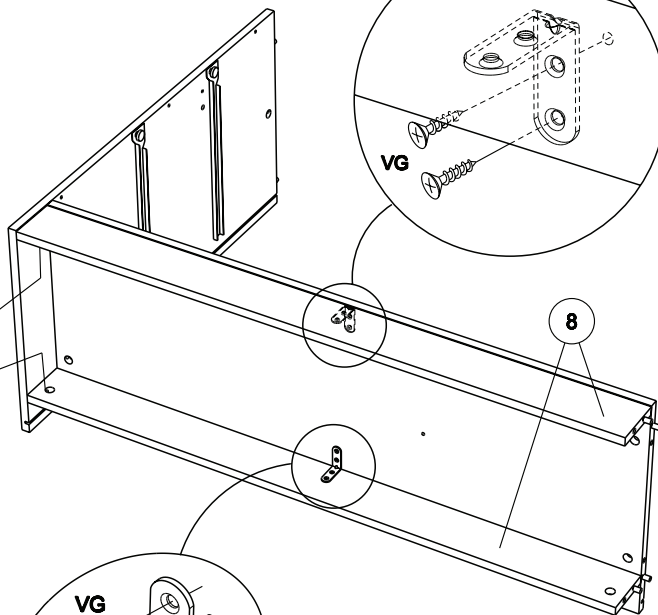
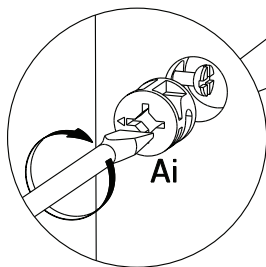
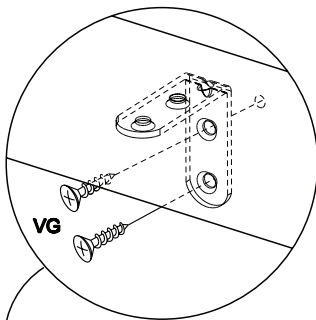
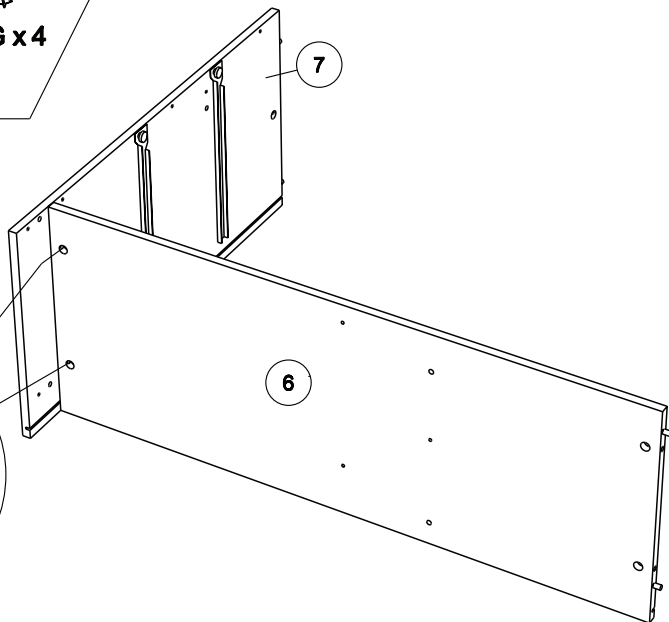
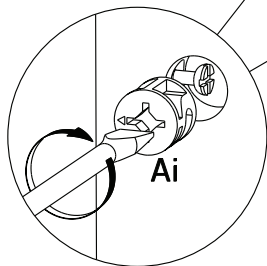

11



Ai x4

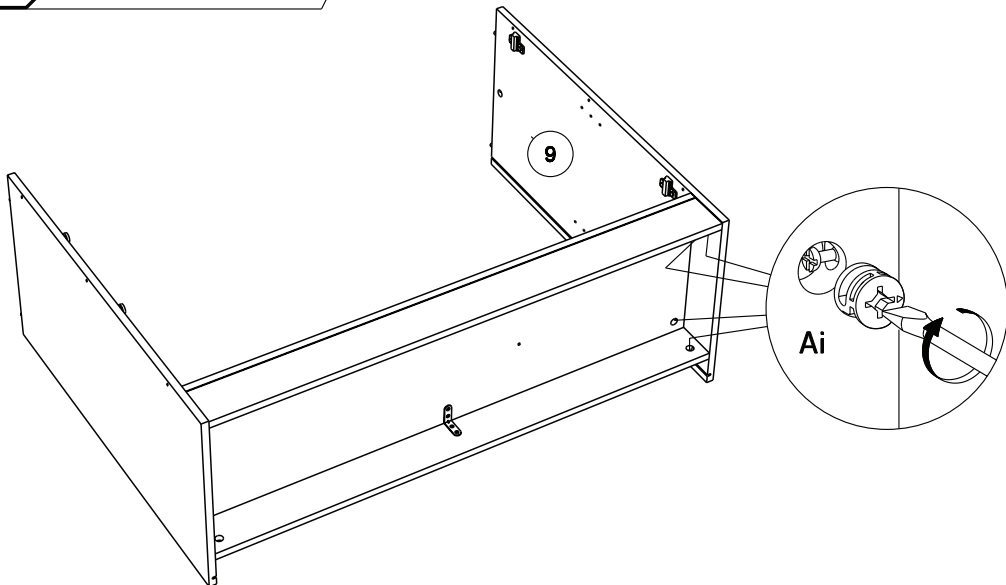

12



BSD x 1

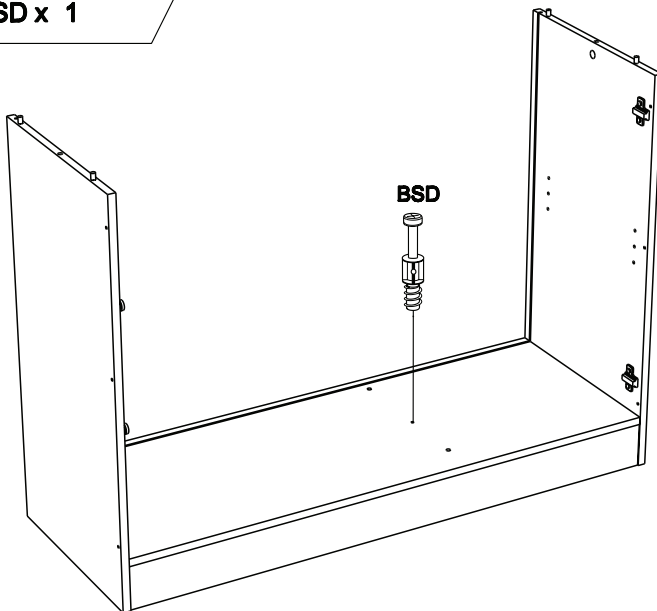

13



Ai x3

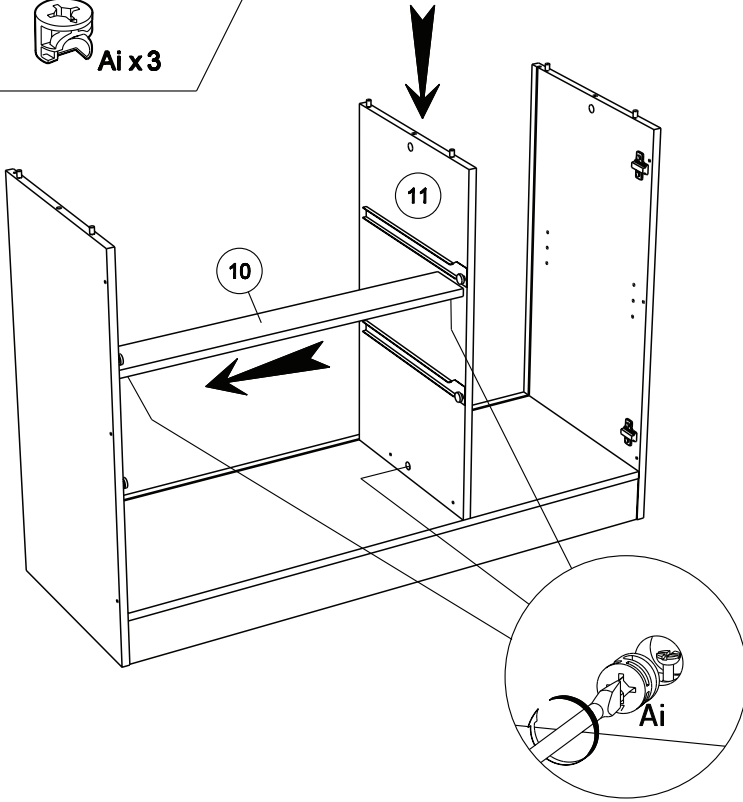

14

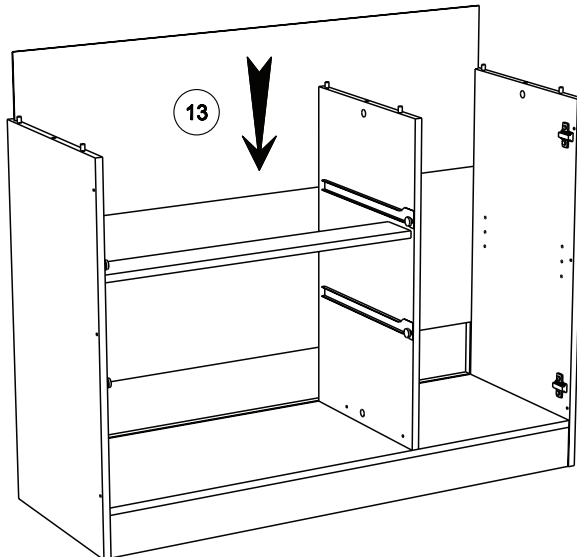

15

BSD x 3

ADM x 2

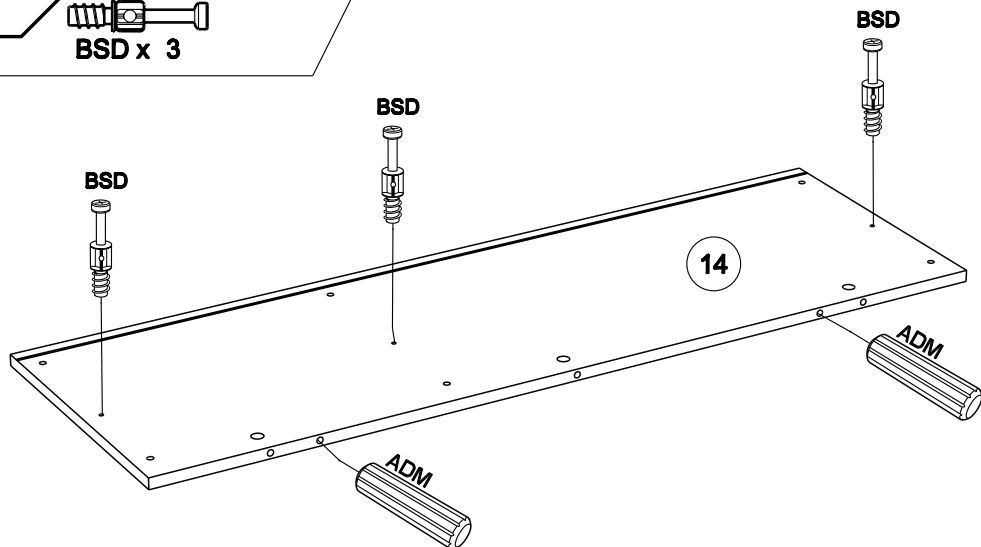

16

AKY x 3

Ai x 3

BJG x 2

ANK x 2

VG x 2

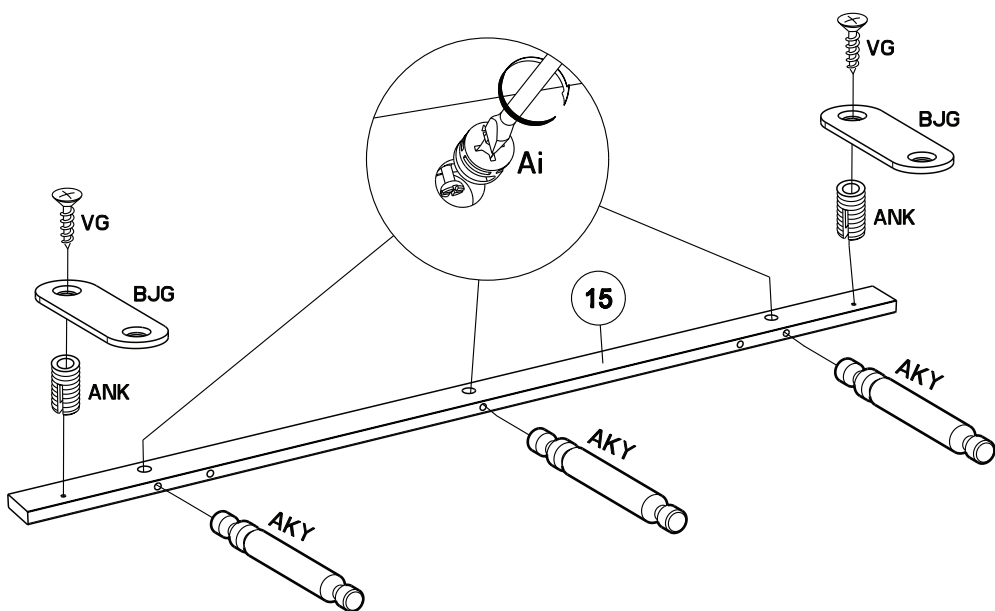

**17**



**Ai x3**

**VG x2**

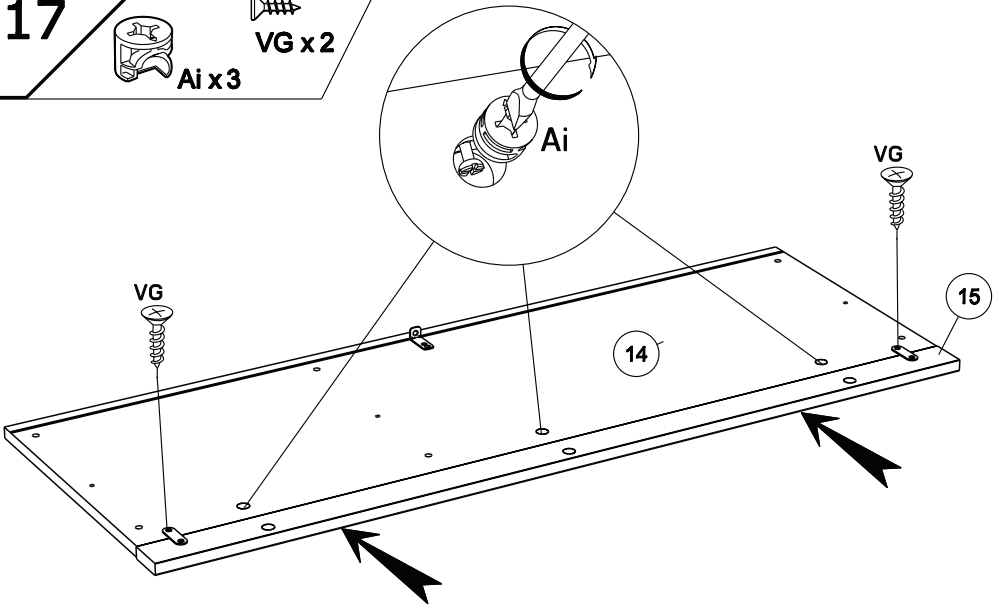

**18**

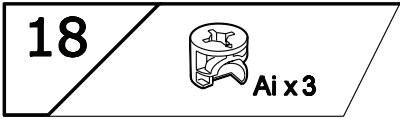

**Ai x3**

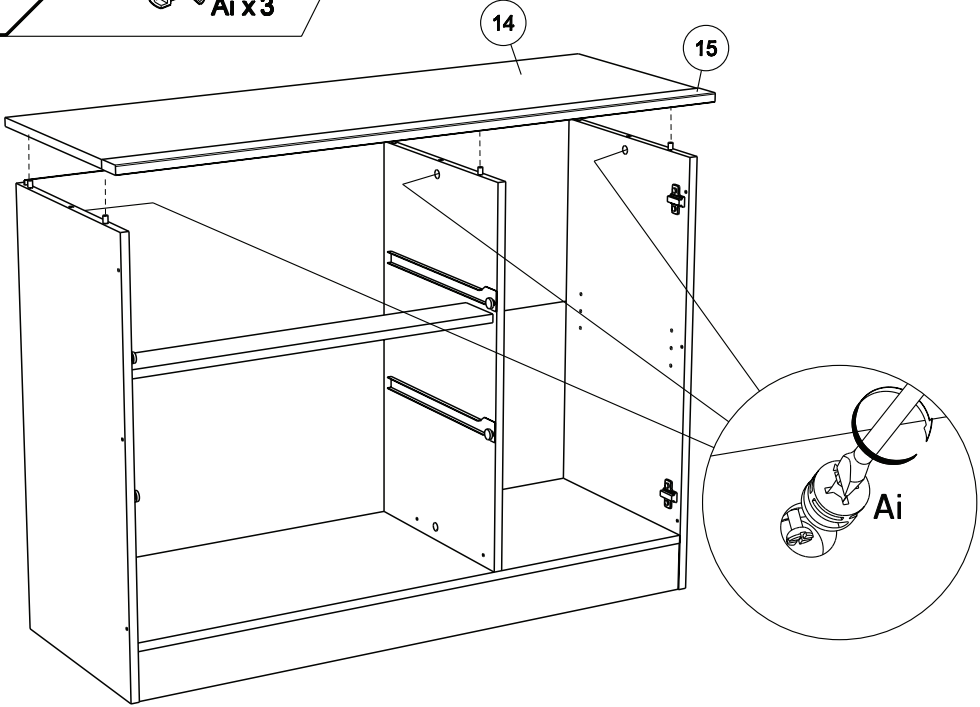



19

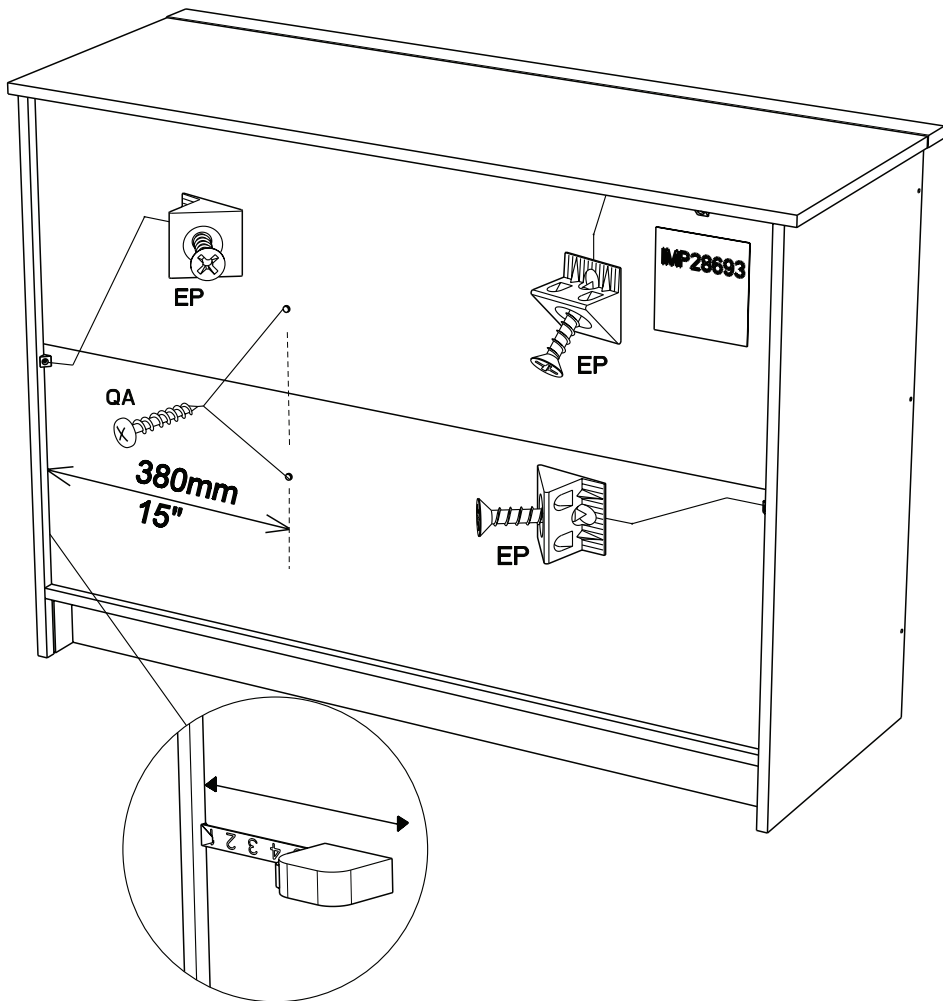
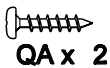

20



WF x 6

WF

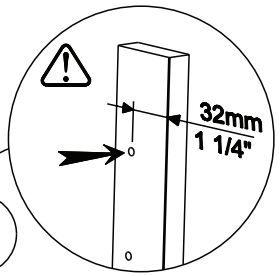

12

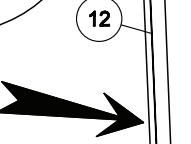
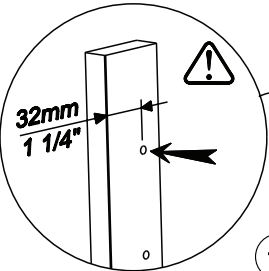
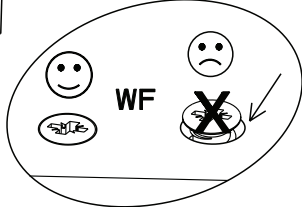
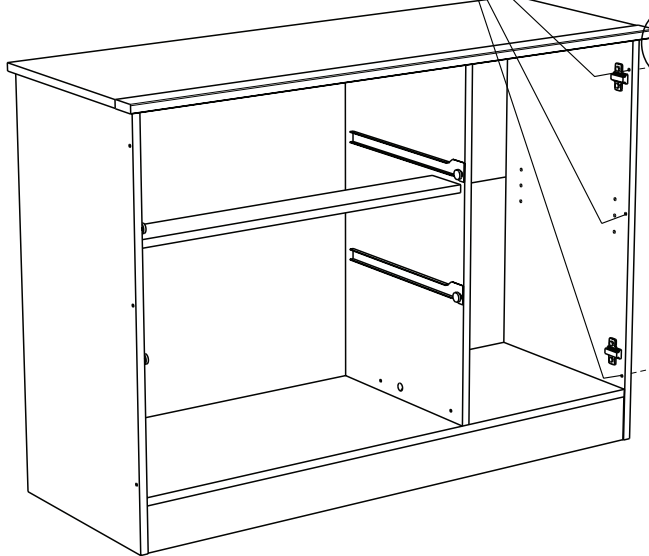

12

WF

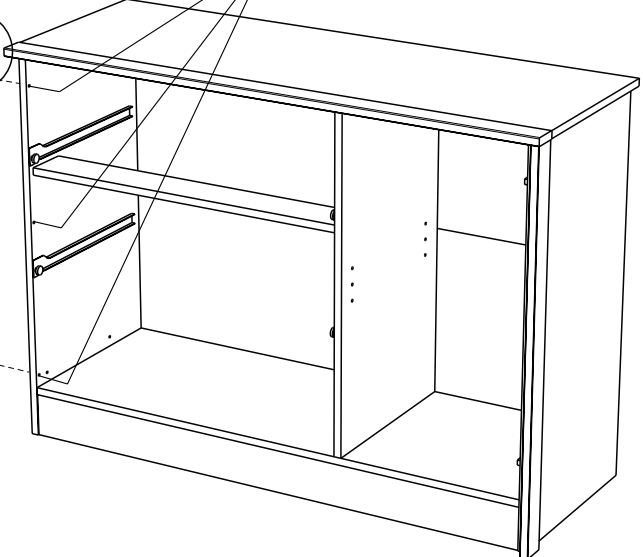
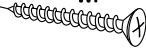

21



AFG x1



AFH x1

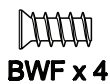

BWF x4



VG x2

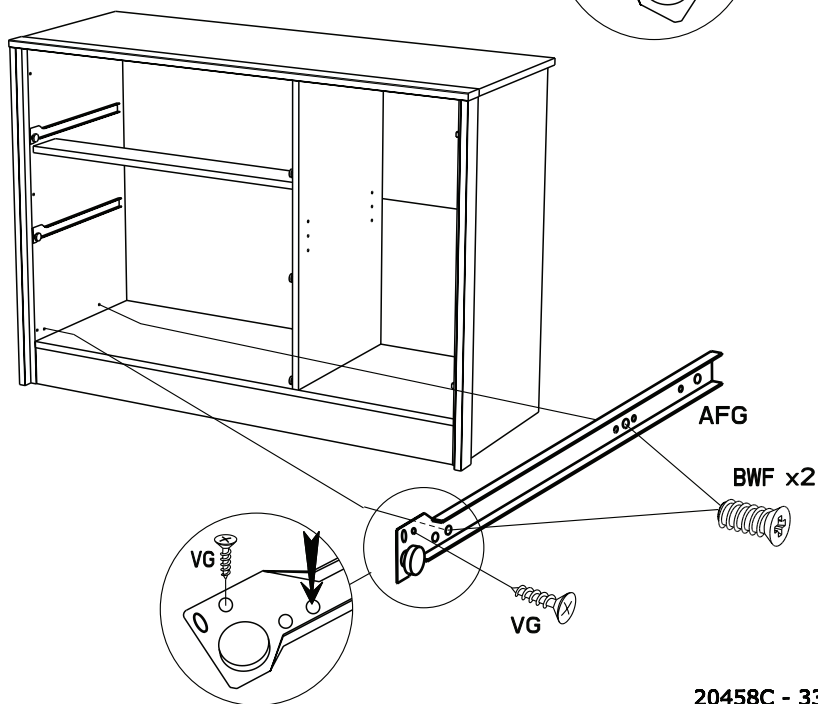
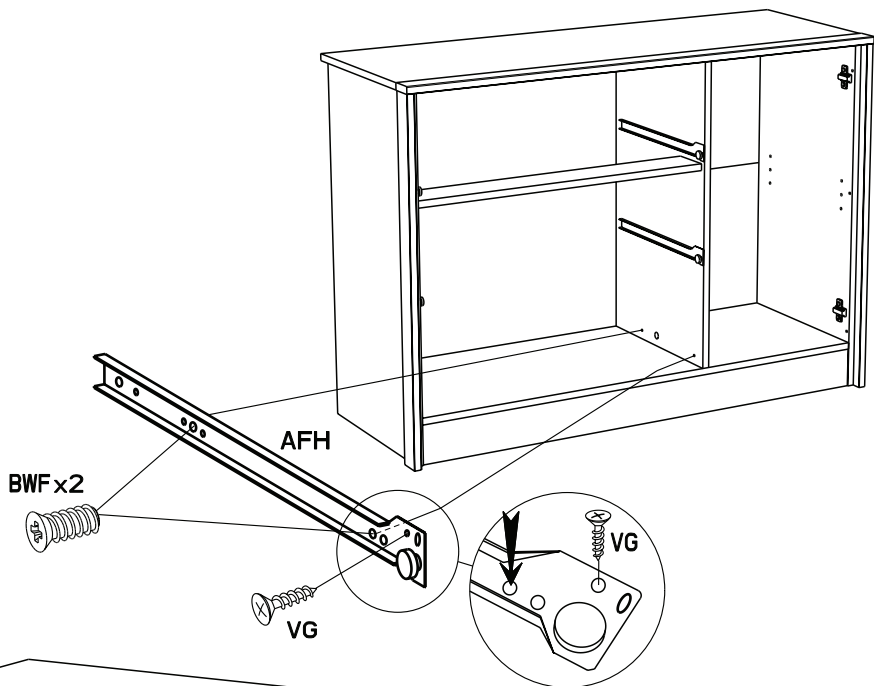

- FR OBLIGATOIRE:** Pour votre sécurité, fixation du meuble au mur.  
Attention, la fixation doit être réalisée par une personne compétente car cela nécessite des chevilles adaptées à la nature de votre mur.
- EN OBLIGATORY:** For your safety, due to risk of overturning, this product must be used with the wall attachment device provided, this should be carried out by a competent person.
- DE OBLIGATORISCH:** Zu Ihrer Sicherheit, befestigen Sie das Möbel an der Wand.  
Achtung: Diese Befestigung ist durch eine fachlich kompetente Person vorzunehmen.  
Hierfür sind für die Bauweise Ihrer Wand geeignete Dübel einzusetzen.
- ES OBLIGATORIO:** Por su seguridad, fijar el mueble a la pared.  
Advertencia: la fijación la ha de llevar a cabo por personal adecuado, ya que requiere el uso de tacos que se adaptan al tipo de pared.
- PT OBRIGATÓRIO:** Para sua segurança, fixação do móvel ao muro.  
Atenção: a fixação deverá ser efetuada por pessoa habilitada, visto que são necessárias cavilhas adaptadas ao tipo de parede.
- IT OBBLIGATORIO:** Avvertenza di sicurezza, il fissaggio del mobile a parete deve essere realizzato da una persona competente, in quanto l'operazione richiede l'impiego di tasselli adatti alla natura del muro.
- NL VERPLICHT:** Voor uw veiligheid, bevestiging van het meubel aan de muur.  
Opgelet de bevestiging moet worden uitgevoerd door een bekwaam persoon daar dit voor uw type muur geschikte pluggen vereist.
- CZ POVINNÝ:** Z bezpečnostních důvodů, upevněte nábytek do zdi.  
Pozor, upevnění je třeba svěřit kompetentní osobě, neboť vyžaduje hmoždinky vhodné pro vaši zeď.
- HU KÖTELEZŐ:** Az Ön biztonsága érdekében, a bútor falra rögzítésre.  
Figyelmeztetés: a rögzítés csak megfelelő szakképesítéssel rendelkező személy által végezhető el, mert a rögzítéshez a falnak megfelelő csavarokra van szükség.
- PL OBOWIĄZKOWY:** Dla bezpieczeństwa, mocowanie mebla do ściany.  
Uwaga, mocowanie musi zostać wykonane przez osobę kompetentną, ponieważ wymaga to zastosowania kołków dostosowanych do rodzaju ściany.
- RO OBLIGATORIU:** Pentru securitatea dumneavoastră, fixarea mobilierului de perete.  
Atenție, fixarea trebuie să fie realizată de o persoană calificată, deoarece sunt necesare dispozitive de fixare adaptate caracteristicilor peretelui dumneavoastră
- RU ОБЯЗАТЕЛЬНЫЙ:** Для вашей безопасности Крепление мебели к стене  
Внимание! Крепление должно производиться опытным специалистом, т.к. для такой установки потребуются штифты, соответствующие типу вашей стены.
- SK POVINNÉ:** Z bezpečnostných dôvodov, nábytok upevnite k stene.  
Dbajte na to, aby upevnenie vykonala kompetentná osoba, pretože pri upevňovaní sa vyžadujú kolíky vhodné do materiálu, z ktorého je stena vyrobená.
- SL OBVEZNO:** Za vašo varnost, Enota naj bo pritrjena na steno. Pozor: To naj stori kompetentna oseba, ker je potrebno uporabiti pravilni nosilec glede na vrsto stene ki jo uporabljate.
- TR ZORUNLU:** Güvenliğinizi için, Mobilyanın duvara sabitlenmesi  
Dikkat, sabitleme işlemi uzman biri tarafından yapılmalıdır çünkü bu işlem için duvarınızın malzemesine uygun dübellerin kullanılması gerekmektedir
- EL ΥΠΟΧΡΕΩΤΙΚΟΣ:** Για την ασφάλειά σας στερέωση των επίπλων στον τοίχο.  
Προσοχή, η στερέωση πρέπει να γίνεται από ικανό άτομο, καθώς απαιτούνται σφήνες προσαρμοσμένες στη φύση του τοίχου σας.

**AR واجب:** لسلامتك الشخصية، تثبيت قطعة الأثاث على الحائط

تحذير، يجب أن يقوم شخص متخصص بعملية التثبيت على الحائط إذ أنها تتطلب أسفينا معيناً يتوافق مع طبيعة الحائط نفسه.

**ZH 義務性:** 为了您的安全，本产品必须靠墙安装。

NB 本产品必须由专业人士安装，且您必须使用符合您的墙壁类型的罗威纤维管。

22

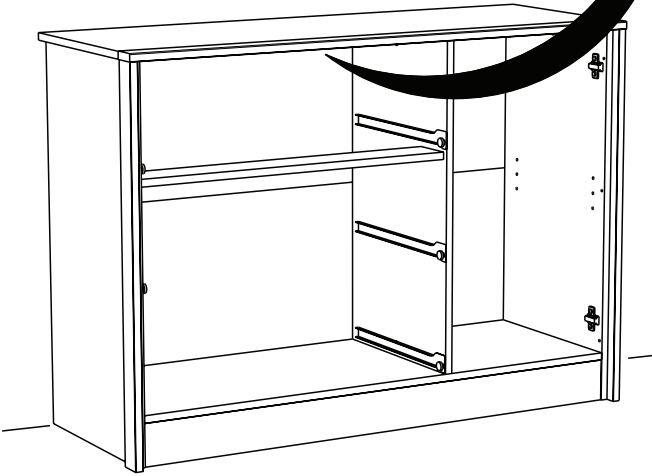
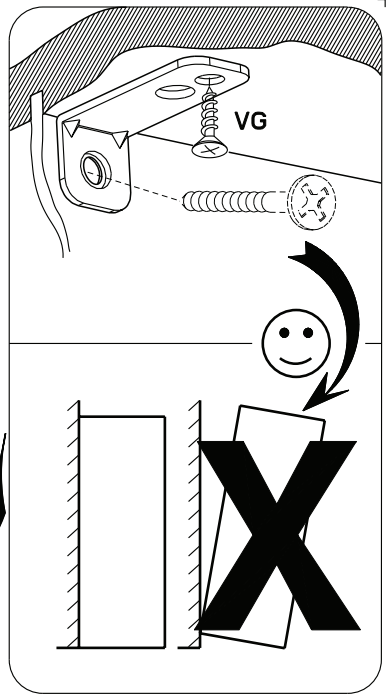
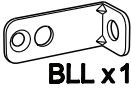

23

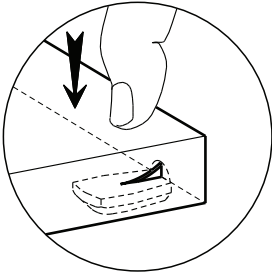
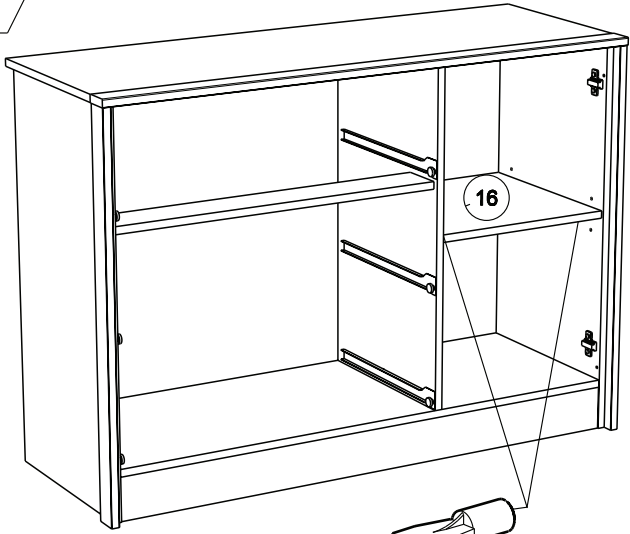

24

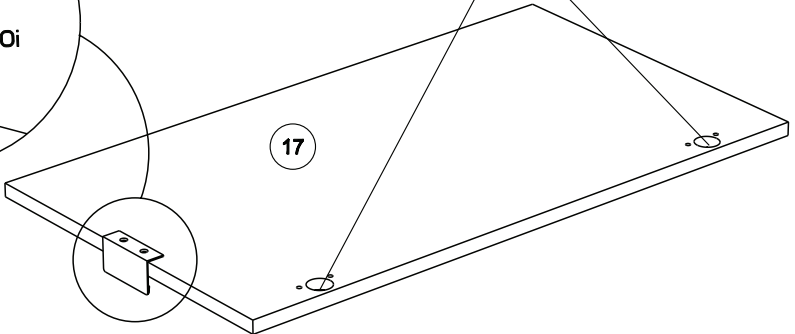
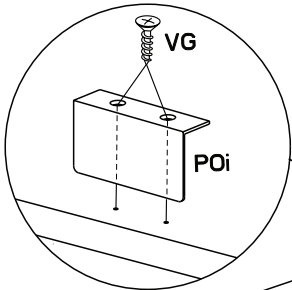
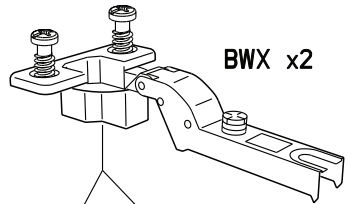
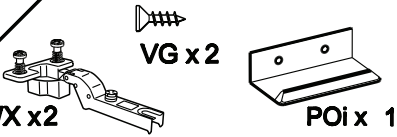

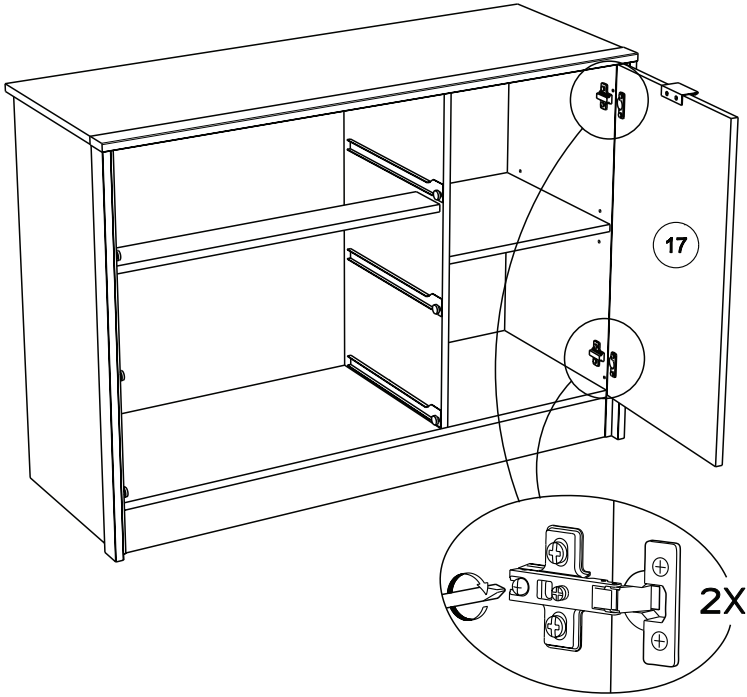

RCH-N

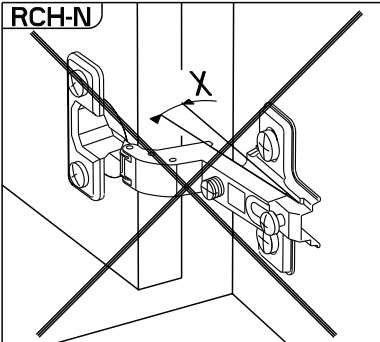

**MONTAGE**

- (GB) LEAFLET AUFBAUANLEITUNG
- (D) MONTAGE ANLEITUNG
- (E) MONTAJE MONTAGEM
- (I) MONTAGGIO MONTAGE
- (NL) AFSTELLING

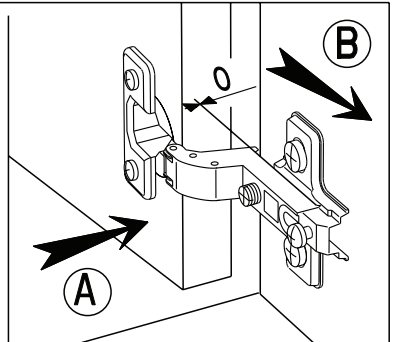

**REGLAGE** (GB) ADJUSTING (E) AJUSTER (I) AGGIUSTAMENTO  
 (D) ANPASSUNG (P) REGULACAO (NL) AFSTELLING

**A**

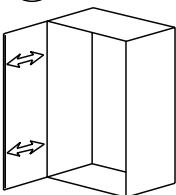

**B**

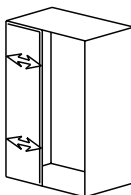

**C**

